

NEW

SATAjet® X 5500 B RP®/HVL



- Revolutionary: The X-nozzles are taking atomization to a whole new level
- Noticeably quieter: Whispering nozzle™ due to optimized air flow geometry, reduced noise level in the relevant sound frequency ranges
- Individual: Matches any application requirement, such as specific characteristics of the paint system, climatic conditions and application method (application speed/application control)
- Precise: Optimized material distribution for enhanced spraying uniformity and atomization with both spray fan shapes
- Low maintenance: No air distribution insert required, thus also ensuring a much easier and faster cleaning process
- Consistent: Constant fan size across the entire nozzle spectrum (within each respective atomization technology) with linear increases of the material flow rate
- Efficient: The optimized atomization concept enables to realize considerable material savings using the same application method as before

SATAjet® X 5500 RP® STANDARD / DIGITAL

Technical Data



www.sata.com/SATAjetX5500

Inlet pressure
 Field of application: 7 psi - 34 psi
 Compliant: max. 29 psi

Air consumption at 29 psi: 10 cfm

Spray distance
 Field of application: 3.9 inches - 8.2 inches
 Recommended: 6.6 inches - 8.2 inches

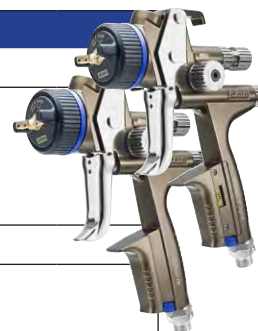

Nozzle	I-nozzle					O-nozzle				
	1.1 l	1.2 l	1.3 l	1.4 l	-	1.1 0	1.2 0	1.3 0	1.4 0	-
Standard with RPS multi-purpose cup 0.6 l / 0.9 l (each 1x) with swivel joint										
Part No.	1061548	1061556	1061564	1061572	-	1061580	1061598	1061605	1061613	-
DIGITAL with RPS multi-purpose cup 0.6 l / 0.9 l (each 1x) with swivel joint										
Part No.	1061639	1061655	1061704	1061738	-	1061770	1061796	1061811	1061837	-
Nozzle	1.1 l	1.2 l	1.3 l	1.4 l	-	1.1 0	1.2 0	1.3 0	1.4 0	-
Nozzle set										
Part No.	1063536	1063544	1063552	1063560	-	1063578	1063586	1063594	1063601	-

SATAjet® X 5500 HVL STANDARD / DIGITAL

Technical Data



www.sata.com/SATAjetX5500

Inlet pressure
 Field of application: 7 psi - 34 psi
 HVL: max. 29 psi

Air consumption at 29 psi: 15 cfm

Spray distance
 Field of application: 3.9 inches - 8.2 inches
 Recommended: 3.9 inches - 5.9 inches

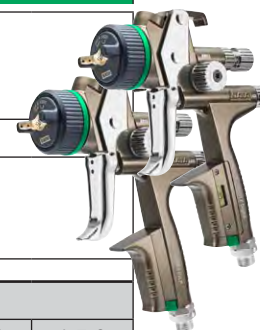

Nozzle	I-nozzle					O-nozzle				
	1.1 l	1.2 l	1.3 l	1.4 l	1.5 l	1.1 0	1.2 0	1.3 0	1.4 0	1.5 0
Standard with RPS multi-purpose cup 0.6 l / 0.9 l (each 1x) with swivel joint										
Part No.	1061895	1061902	1061887	1061910	1061928	1061936	1061944	1061952	1061960	1061978
DIGITAL with RPS multi-purpose cup 0.6 l / 0.9 l (each 1x) with swivel joint										
Part No.	1062009	1061986	1062017	1062041	1062059	1062083	1062091	1062132	1062140	1062174
Nozzle	1.1 l	1.2 l	1.3 l	1.4 l	1.5 l	1.1 0	1.2 0	1.3 0	1.4 0	1.5 0
Nozzle set										
Part No.	1063619	1063627	1063635	1063651	1063669	1063677	1063685	1063643	1063693	1063700

Spare Parts SATAjet® X 5500

Part No./Description	
240	Packing, Air Piston (each)
15438	Paint needle packing
16162	Swivel joint for digital gun
19745	Swivel joint
17897	Needle spring
86843	Air piston rod
96875	Seal, insert for paint spray guns w/QCC cup connection
133934	Gasket (3x) for spindle
133942	Seal retainer, cpl.
133959	Pressure spring (3x) for paint needle and air piston
133991	Packing, Air Piston (3x)
134098	Air connection piece G1/4 male thread
140582	Sealing element (5x) for fluid tip
211391	Locking screw (3x) for air micrometer
211409	CCS-Clips, green, blue, red, black (each 1x)
211433	Trigger kit
211441	Seal retainer with sleeve
211458	Trigger sleeve kit
211466	Air micrometer
211474	Material flow control with counter nut
211508	Sealing ring (5x)
213025	Spindle, cpl., for round / flat spray control, 1 each
215806	Air Piston Spring
1057323	Tool kit
1057357	Control knob with blk screw, pkg unit 2 pieces
1057414	Battery kit

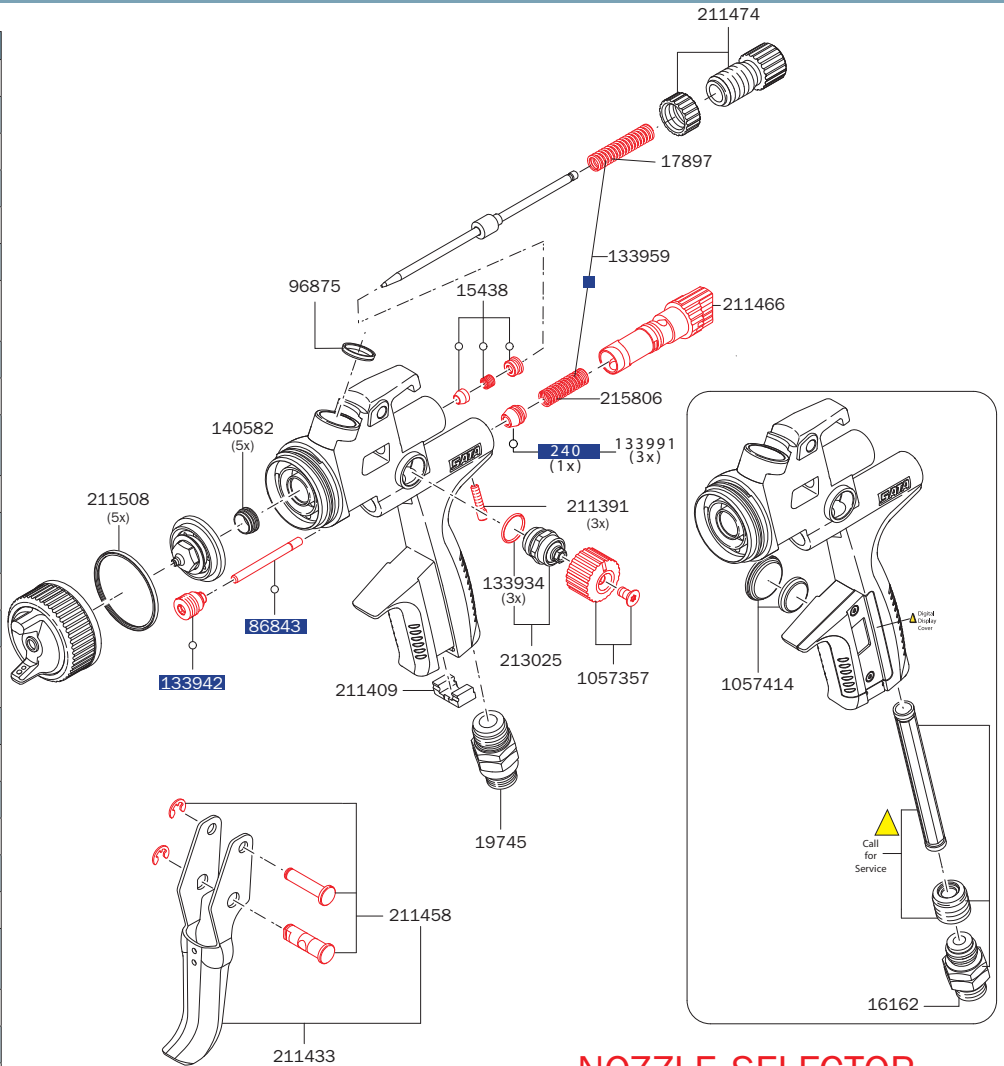

NOZZLE SELECTOR

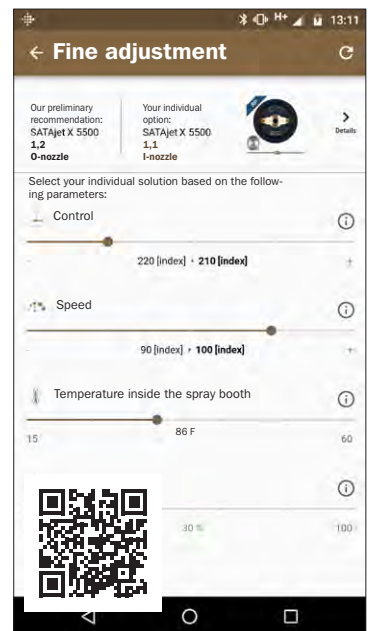

www.sata.com/nozzlefinder

SATA adam 2 (SATAjet 5000 series only)

Part No./Description	
211557	SATA adam 2 (psi)
211565	SATA adam 2 dock
211573	SATA adam 2 dock (2x)

WARNING
on DIGITAL GUNS
Removing the DIGITAL air inlet tube or the DIGITAL display cover
VOIDS WARRANTY
It must be returned for service otherwise it will not function properly

Part No./Description	
1057323	Tool kit
	<ul style="list-style-type: none"> Universal spanner Cleaning brush 198598 Combi tool Paint strainer CCS-Clip Kit

Part No./Description
1047522
Repair kit
82552
Air piston service unit
136960
Sealing kit

Technical modifications and printing errors reserved